

10

Voltear el mueble con cuidado
Turn over the cabinet carefully

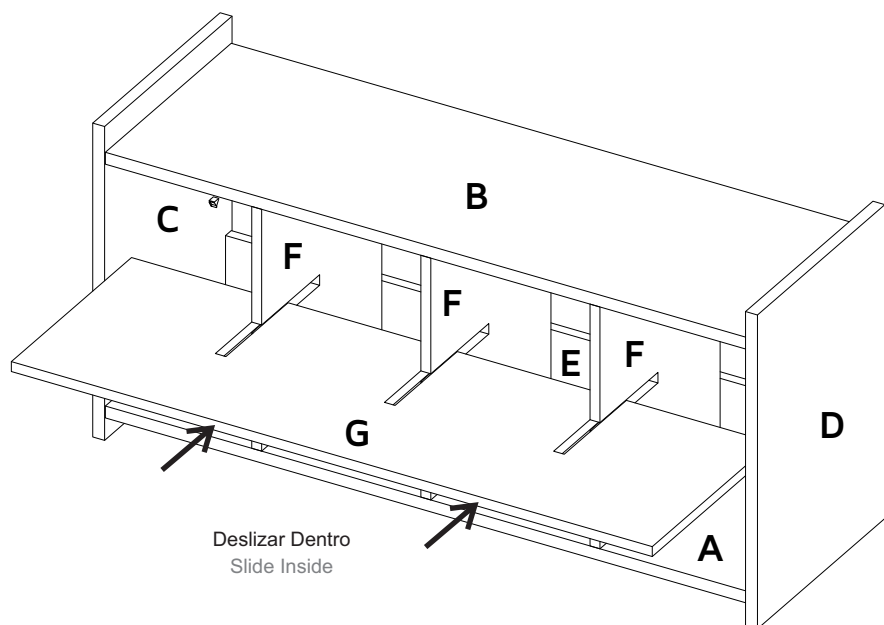

Después de ajustar todas las cajas minifix, cúbralas con las tapas adhesivas.
After you finish the adjustment of the cams, cover them with the cover caps.

A

Al terminar de armar, desprenda las letras adhesivas.
After you finish assembling the cabinet, take off the adhesive letters.

RTA[®]
m u e b l e s

INSTRUCCIONES DE ENSAMBLE ASSEMBLY INSTRUCTIONS

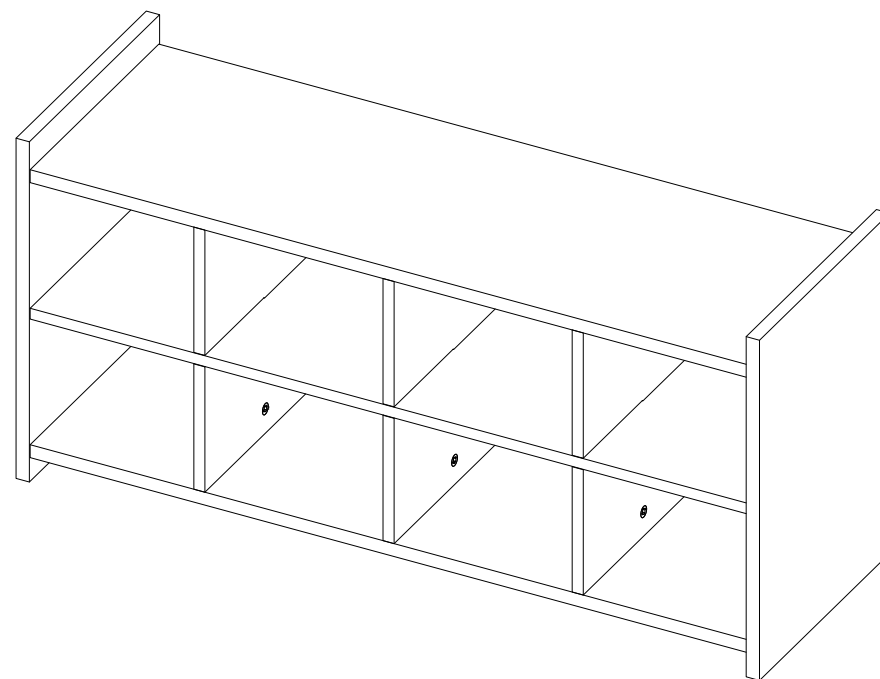

Alto: 48,1 cm Height: 18,94 in
Ancho: 100,6 cm Width: 39,61 in
Fondo: 33,4 cm Depth: 13,15 in

LOT N°

REF./SKU. ZCG 5834

Tel - (572) 691 17 00
PBX - (572) 695 91 81
Yumbo - Valle del Cauca - Colombia
www.rta.com.co

ZAPATERO RECIBIDOR Z-101
Z-101 Entryway Storage Unit

RECOMENDACIONES IMPORTANTES

No pintar el mueble.

El mueble debe ser usado únicamente en interiores, no exponer al sol directo.

Limpiar los herrajes metálicos con un paño seco.

NO sobrecargar el mueble (ver las cargas sugeridas).

No golpear ni martillar el mueble (solo cuando se indique).

Limpiar con un paño ligeramente húmedo, usar jabones suaves.

No arrastre el mueble, levántelo entre dos personas.

Evite el contacto directo con el agua, el fuego o la exposición a fuentes de calor.



ADVERTENCIA

Nunca permita que los niños escalen o manipulen el mueble, la caída de este puede provocar lesiones graves o la muerte.

IMPORTANT RECOMMENDATIONS

Do not paint the cabinet.

The cabinet **MUST** be used exclusively indoors, do not expose to direct sun.

Clean metallic hardware with a dry cloth.

Do **NOT** overload the cabinet (see suggested loads).

Do not hit or hammer the cabinet (just when indicated).

Clean with a slightly damp cloth, use gentle soaps.

Do not drag, lift and move between two people.

Avoid direct contact with water, fire or exposure to heat sources.



WARNING

Never allow children to climb or manipulate the cabinet, furniture tip over can cause serious injuries or death.

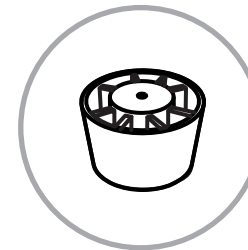
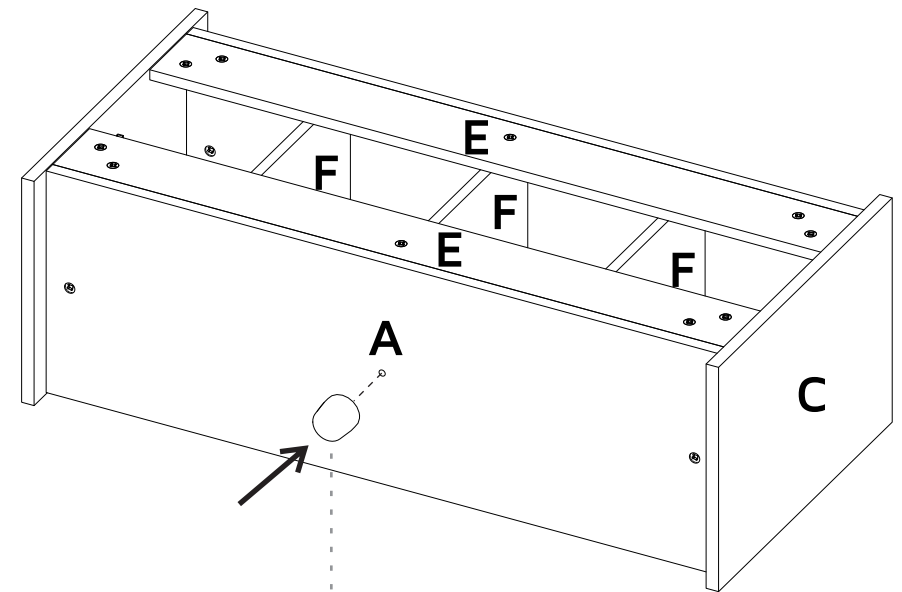

12

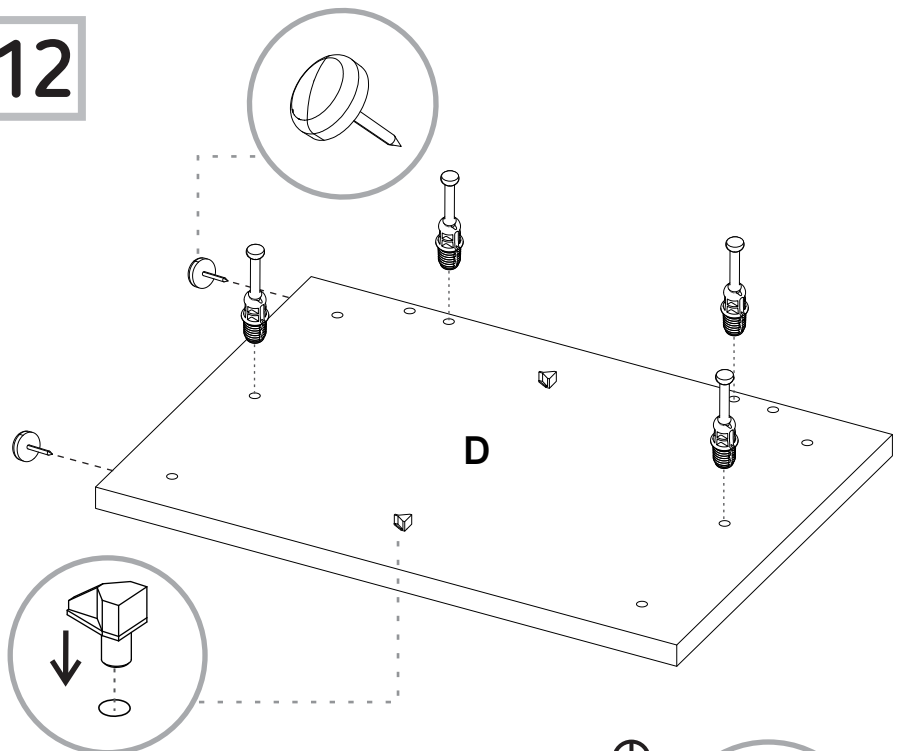

13

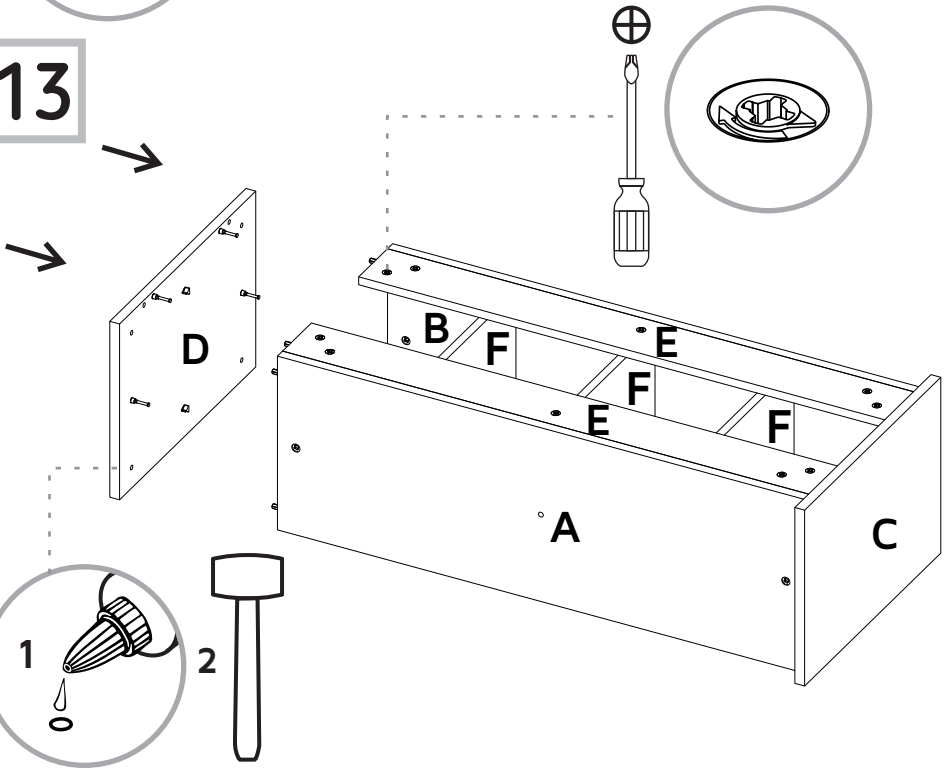

ÍNDICE INDEX

Herrajes para armado Assembly Hardware.....	4
Piezas de armado Assembly Parts.....	5
Cargas sugeridas Suggested loads.....	6
Recomendaciones de ensamble Assembly recommendations.....	6
Pasos de armado Assembly steps.....	7-16

HERRAMIENTAS NECESARIAS* REQUIRED TOOLS*

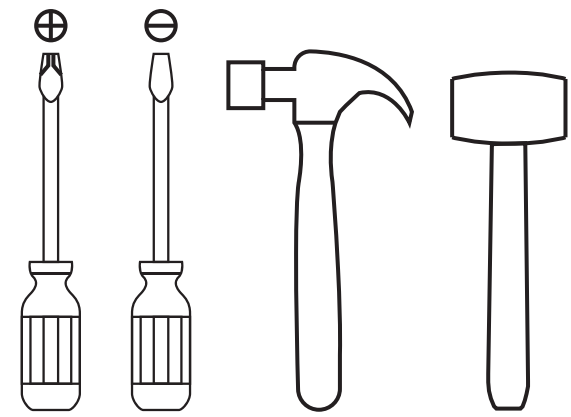

*No incluidas y no se muestran en tamaño real.
*Not included, and not shown actual size.

HERRAJES PARA ARMADO

ASSEMBLY HARDWARE

Compruebe que el contenido de los herrajes sea el correcto. En caso de que falte alguna pieza, por favor llame a nuestra línea de atención al cliente.

Please check that the hardware content is correct. If any item is missing, please call to our customer service line.

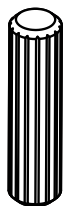

x32
Tarugo
Wood Dowel



x20
Minifix
Minifix Cams

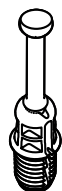

x20
Perno Minifix
Spreading Bolt

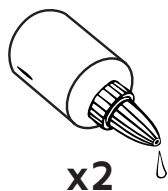

x2
Pegante
Glue



x16
Tapa Adhesiva
Minifix
Cover Caps



x4
Tapa Adhesiva
Minifix
Cover Caps

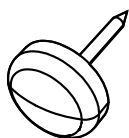

x4
Deslizador Puntilla
Nail-on Glide

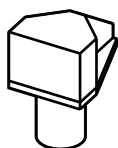

x4
Soporte Entrepaño
Shelf support

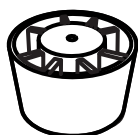

x1
Deslizador 40mm
Plastic Glide

Voltear el mueble con cuidado
Turn over the cabinet carefully

11

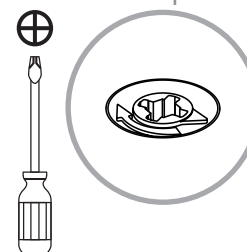
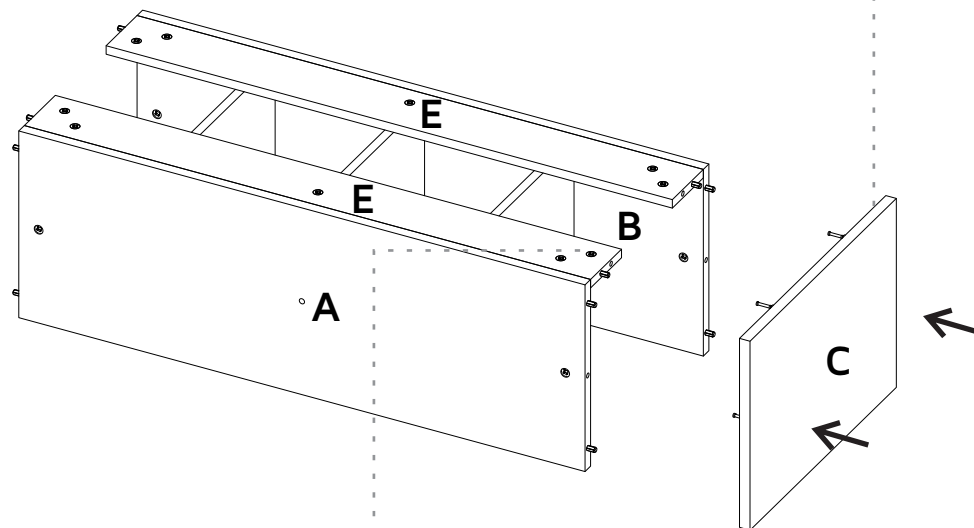
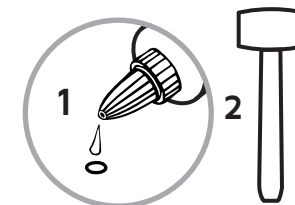

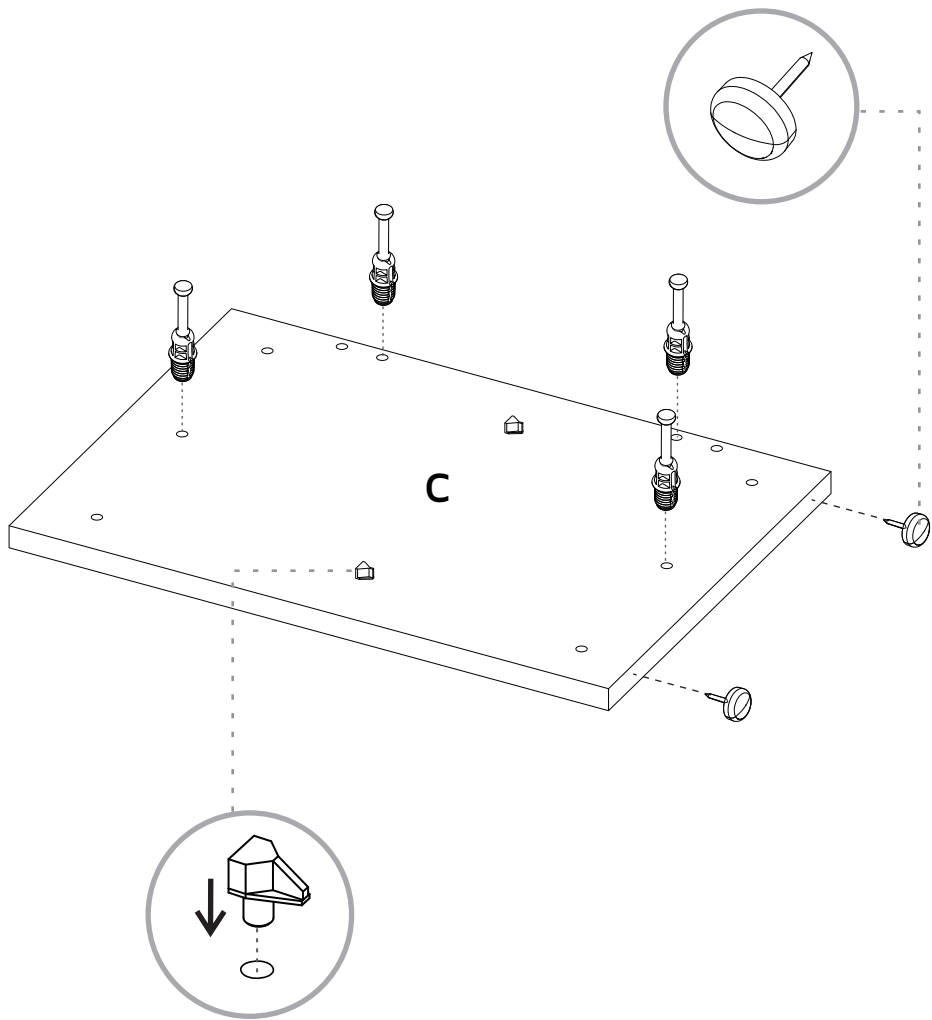

PIEZAS DE ARMADO
ASSEMBLY PARTS

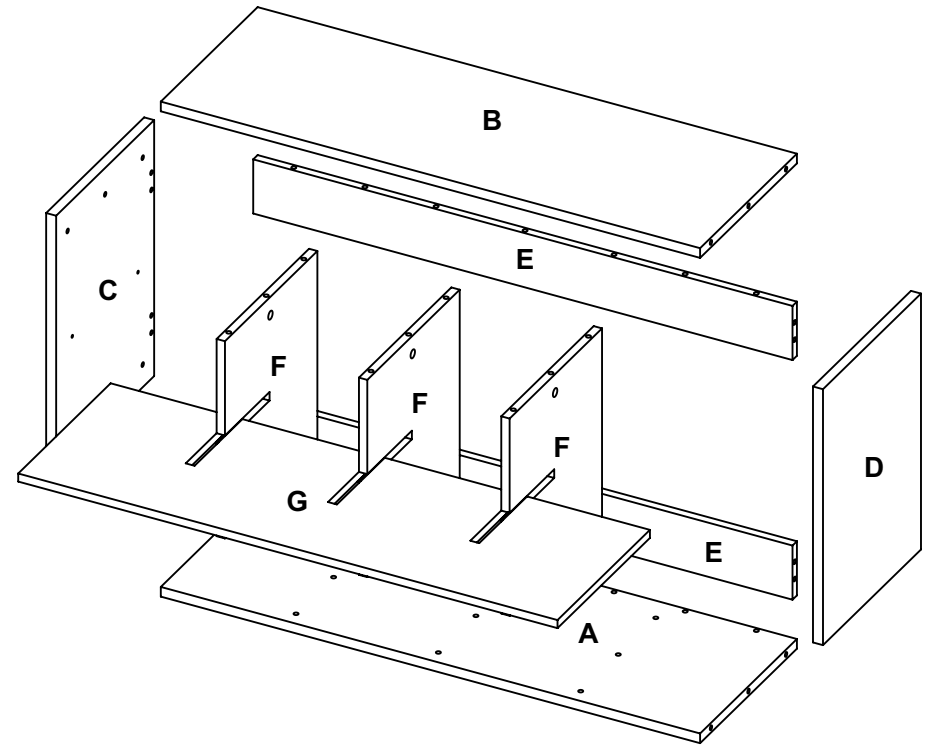

A - x1	E - x2
B - x1	F - x3
C - x1	G - x1
D - x1	

CARGAS MÁXIMAS SUGERIDAS MAX SUGGESTED LOADS

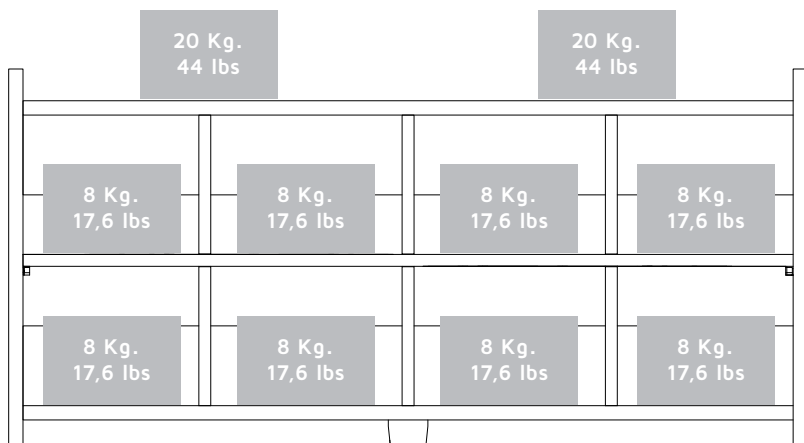

RECOMENDACIONES DE ENSAMBLE ASSEMBLY RECOMMENDATIONS

Ensamble el mueble entre dos personas.

Assemble the cabinet between two people.

Ensamble el mueble sobre una superficie plana y lisa, preferiblemente sobre un tapete o el cartón de la caja

Assemble the cabinet on a flat, smooth surface, preferably on a carpeted floor or the box carton.

Lea cuidadosamente las instrucciones e identifique todas las piezas y herrajes antes de empezar a armar el mueble.

Carefully read all the steps and identify all the wood parts and hardware before assembling the cabinet.

9

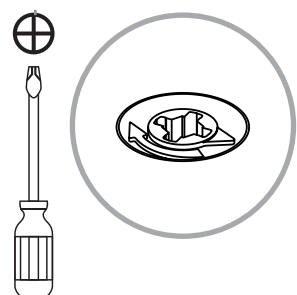
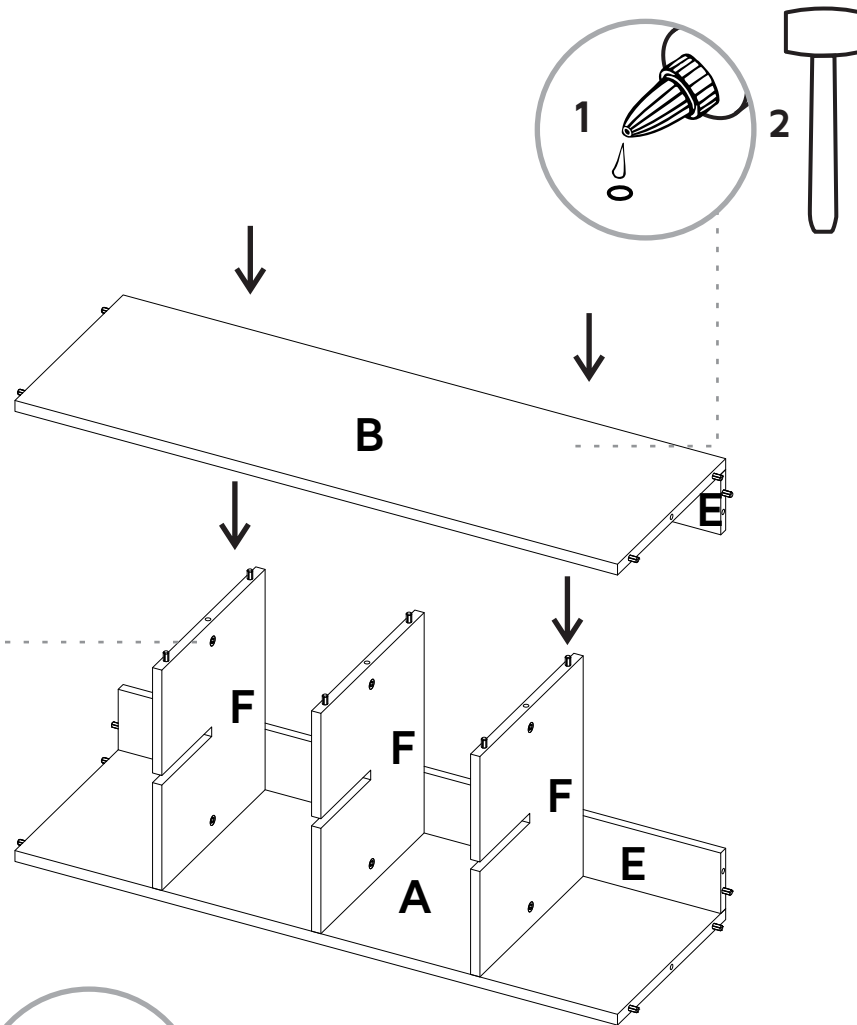

7

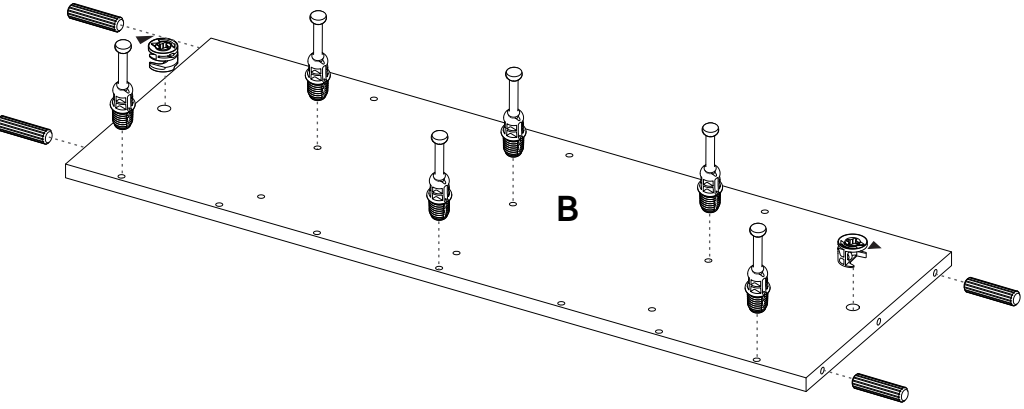

8

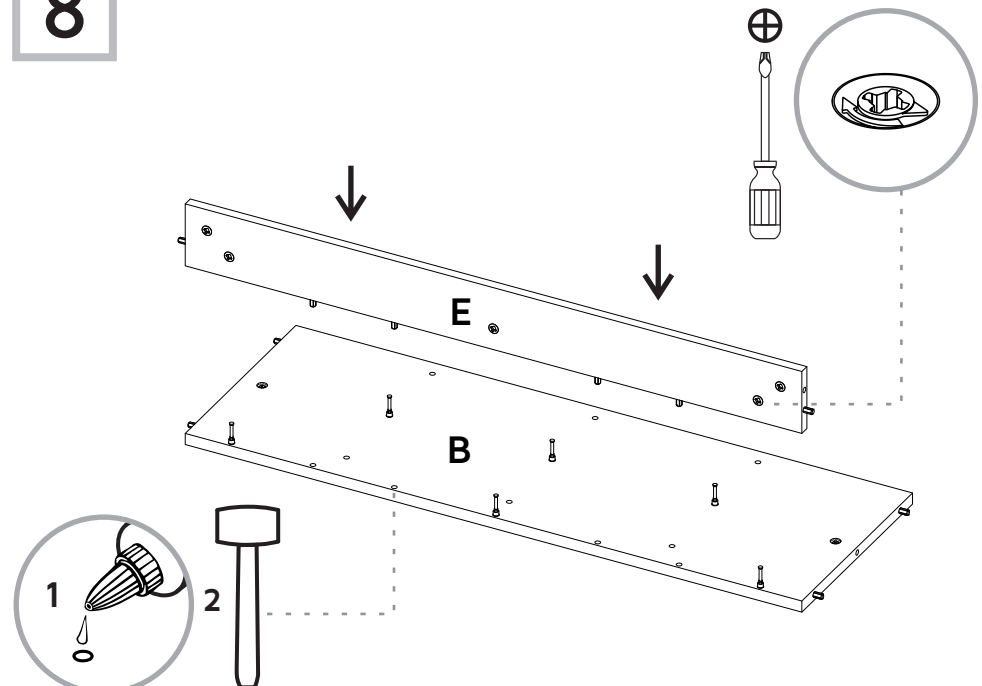

1

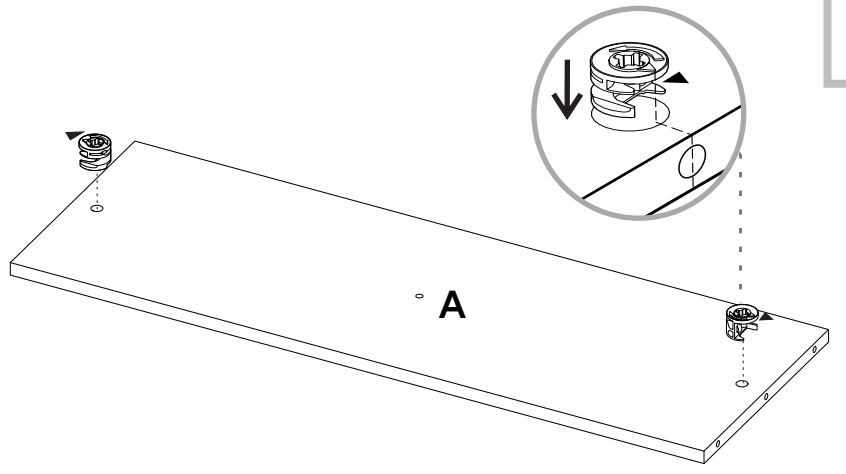

Voltear
Turn over

Repita esto en todos los ensambles
Repeat this in the following steps.

2

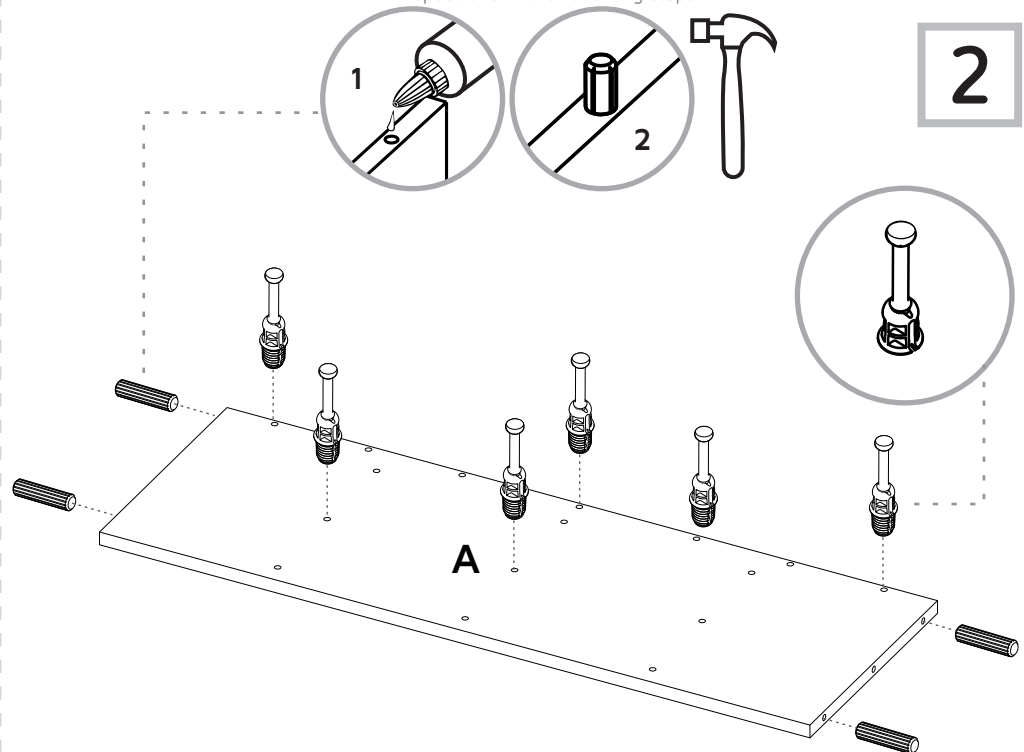

3

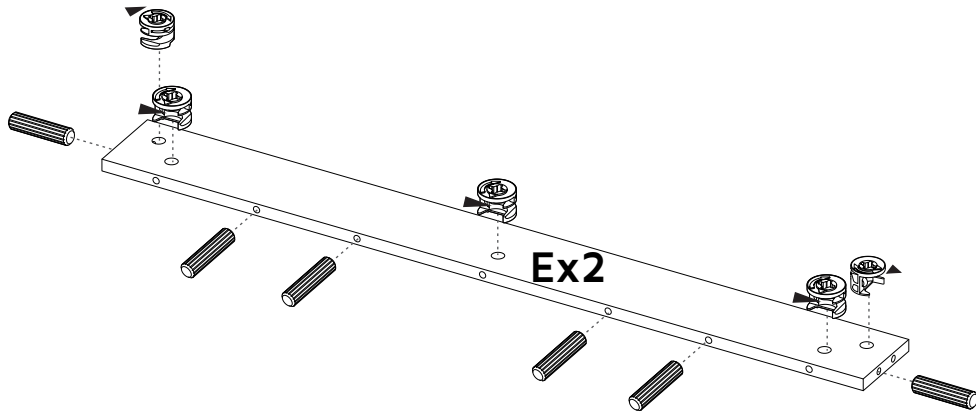

4

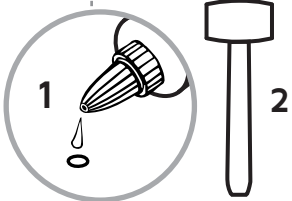
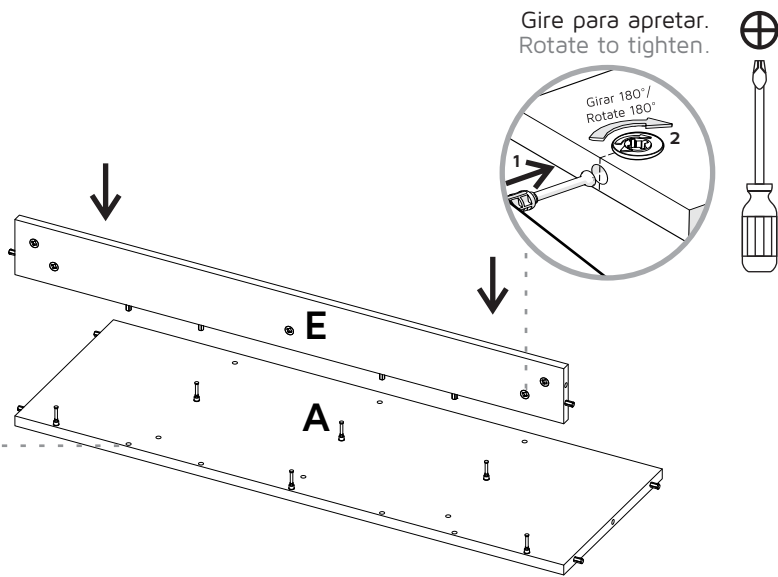

Aplique una gota de pegamento y golpee suavemente la pieza para ajustar el ensamble. Repita esto en todos los ensambles
Gently hit the pieces with a rubber hammer to adjust the joint. Repeat this in the following steps.

5

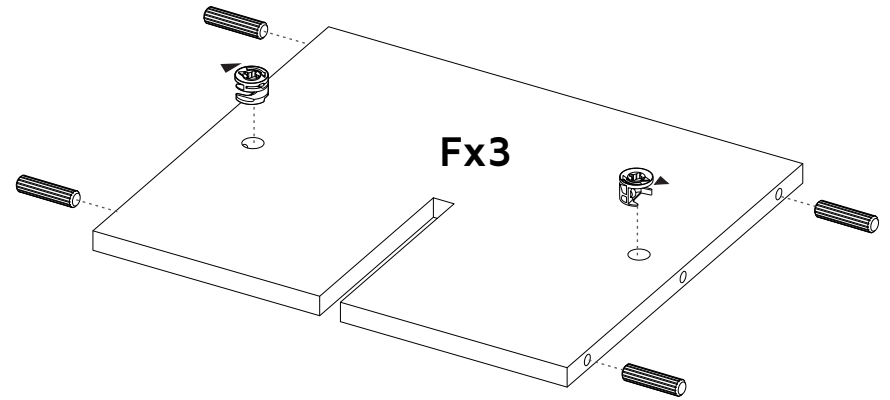

6

